

ROAD PROJECTS

- 2011 SEAL COAT
- 2012 SEAL COAT
- 2013 SEAL COAT
- 2014 SEAL COAT
- 2015 SEAL COAT
- 2016 SEAL COAT
- 2017 SEAL COAT
- 2018 SEAL COAT
- 2019 SEAL COAT
- 2020 SEAL COAT
- 2021 SEAL COAT
- OTHER PROJECT

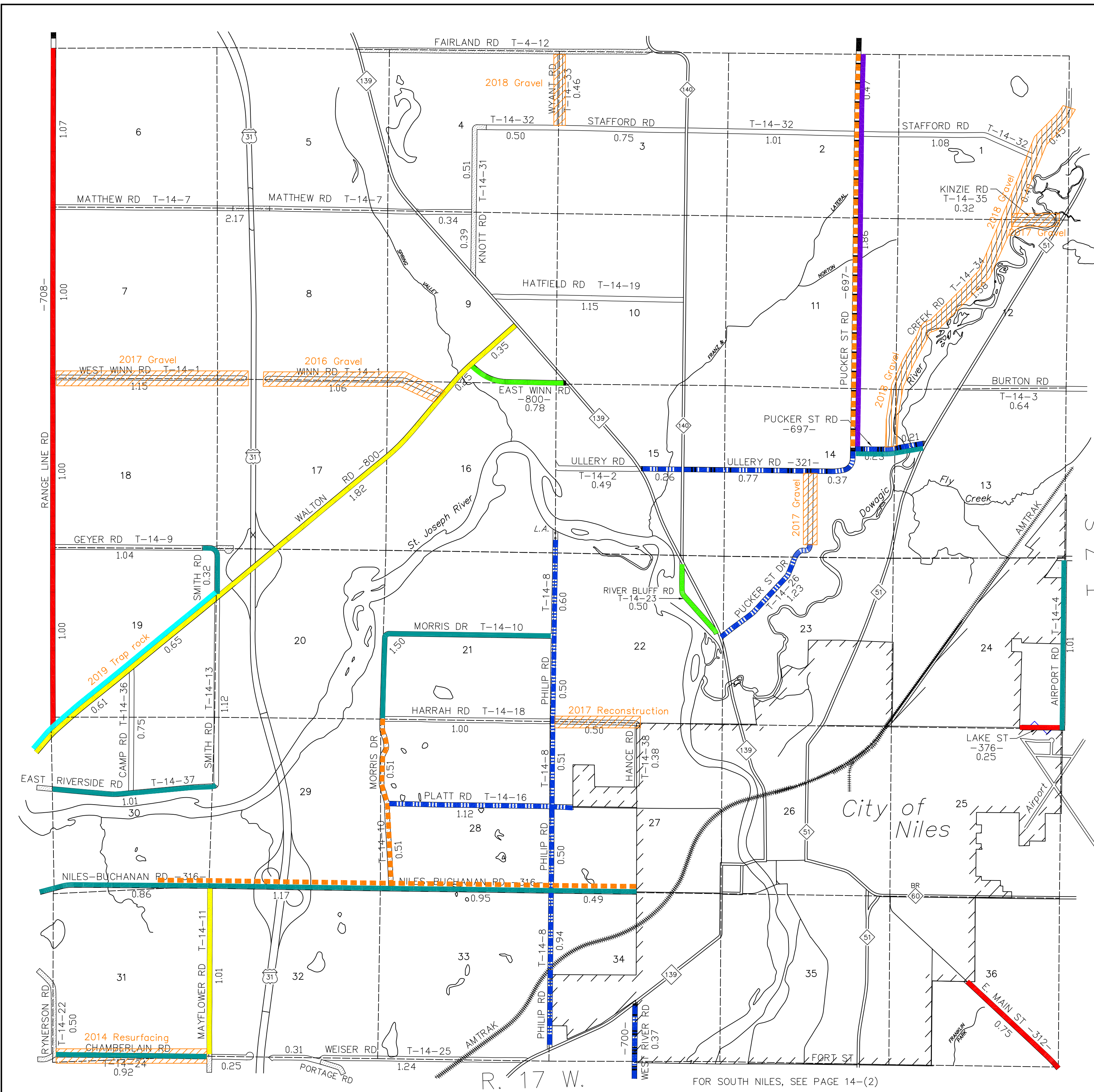

T. 7 S.

LEGEND

- INTERSTATE HIGHWAY
- STATE HIGHWAY
- COUNTY ROAD; PRIMARY SYSTEM (PAVED)
- COUNTY ROAD; LOCAL SYSTEM (PAVED)
- COUNTY ROAD; LOCAL SYSTEM (UNPAVED)
- PRIVATE ROAD
- PUBLIC ROAD (NOT OPEN)
- ADJACENT COUNTY ROAD
- RAILROADS

PRIMARY ROAD SYSTEM IS 17.54 MILES  
 LOCAL ROAD SYSTEM IS 34.23 MILES

NILES TOWNSHIP

BERRIEN COUNTY  
 ROAD DEPARTMENT  
 BENTON HARBOR, MICHIGAN  
 KEVIN STACK, COUNTY HWY ENGINEER  
 SCALE: 1"=2000' DATE: October, 2021  
 No. 14-(1)

FOR SOUTH NILES, SEE PAGE 14-(2)